

## WALLMOUNTED 2 PYLON SYSTEM FOR DISPLAYS FROM 65-86"

ELECTRICAL HEIGHT ADJUSTABLE, 70 CM STROKE

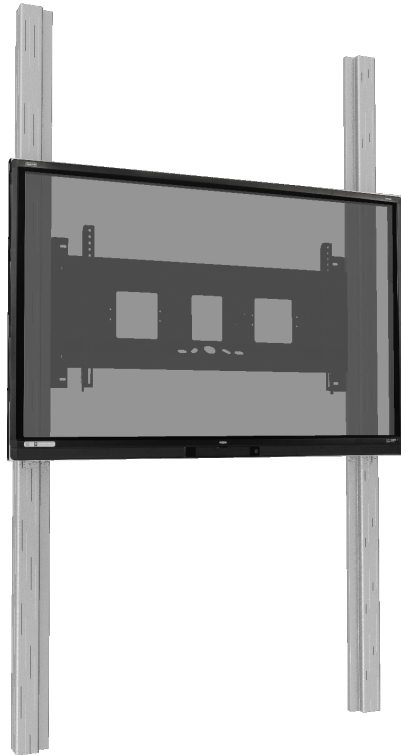

### PRODUCT

This electrically height-adjustable pylon-system is compatible with all touch screen displays available on the market from 65" to 86" screens. The adjustable pylon-system consists of two aluminum profiles mounted on the wall and floor, in which the motor is concealed.

By using the two button remote attached to the system, you can adjust the display to the desired working height. This ensures that every user can work and present at their ergonomically best height.

Advantage of the electrical height adjustment: It increases the lifespan of the display, because controlled movement protects the technology.

### Accessories



Keyboard shelf



2 galvanized adjustable wall mounting brackets



2 galvanized wall mounting brackets



Swivel arm for notebooks

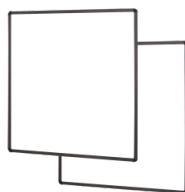

Whiteboard wings for AFSCETAN12

### FEATURES

- Electrically height adjustable system with 2 pylons for floor and wall mounting
- Pylon length 2600 mm
- 70 cm of motorized height adjustment
- All connections on the display are freely accessible
- Optionally with whitboard side wings



Display mount



Wall mounted



Motorized height adjustable



Single display



Max. load  
120 kg / 264.6 lbs



Max. Vesa  
800 x 600

Item number	PY1E-IFPD-W	
Vesa horizontal / Vesa vertical	200 mm - 800 mm / 200 mm - 600 mm	
Frame for all	65" - 86"	
Load capacity	120 kg	264.6 lbs
Width / Height / Depth	1650 mm / 2600 mm / 134 mm	65" / 102.4" / 5.3"
Frame color	RAL 9005 deep black	
Column color	Silver anodized	
Packages	Package dimensions WxHxD	Package weight
AF-PY-N12	460 x 1300 x 70 mm / 18.1 x 51.2 x 2.8"	12,1 kg / 26.7 lbs
CO10284		
CO11635		

DIMENSIONS

in mm / inch

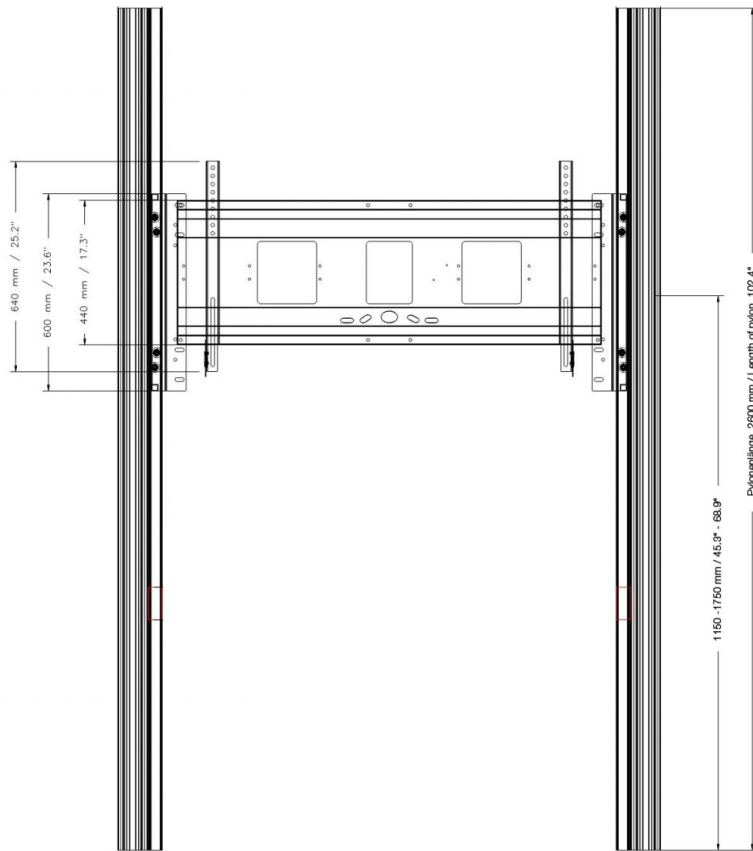

MANUFACTURER:

CONEN Produkte GmbH  
 Conenstr. 4  
 54497 Morbach-Gonzerath

Phone: +49 (0) 6533 75-100  
 Fax: +49 (0) 6533 75-600  
 E-Mail: info@conenmounts.com

Germany

[www.conenmounts.com](http://www.conenmounts.com)