

## WALL MOUNTED 2 PYLON SYSTEM FOR DISPLAYS FROM 65-86"

ELECTRICAL HEIGHT ADJUSTABLE, 70 CM STROKE, WITH WIDEBOARD SIDE WINGS

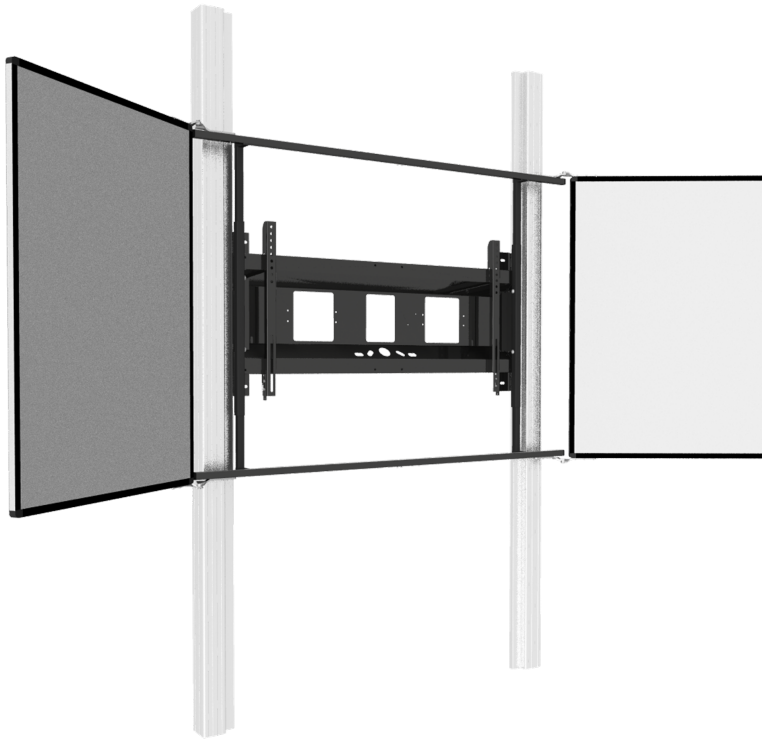

### PRODUCT

This electrically height-adjustable pylon-system with 2 whiteboard side wings is compatible with all touch screen displays available on the market, from 65" to 86" screens. The adjustable pylon-system consists of two aluminum profiles mounted on the wall and floor, in which the motor is concealed.

The two side wings allows you to have both a digital touch panel and a traditional writing surface. The 2 double-sided pivoting whiteboard surfaces can be written on with whiteboard markers are dry wipeable and come with a magnetic surface.

By using the two button remote attached to the system, you can adjust the display to the desired working height. This ensures that every user can work and present at their ergonomically best height.

Advantage of the electrical height adjustment: It increases the lifespan of the display, because controlled movement protects the technology.

### Accessories



2 galvanized adjustable wall mounting brackets



2 galvanized wall mounting brackets



Swivel arm for notebooks

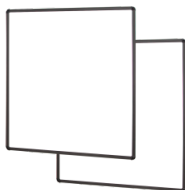

Whiteboard wings for AFSCETAN12

### FEATURES

- > Electrically height adjustable system with 2 pylons for floor and wall mounting
- > Pylon length 2600 mm
- > 70 cm of motorized height adjustment
- > All connections on the display are freely accessible
- > With whiteboard side wings



Display mount



Wall mounted



Motorized height adjustable



Single display



Max. load  
120 kg / 264.6 lbs



Max. Vesa  
800 x 600

Item number	PYKLE-IFPD-W	
Vesa horizontal / Vesa vertical	200 mm - 800 mm / 200 mm - 600 mm	
Frame for all	65" - 86"	
Load capacity	120 kg	264.6 lbs
Width / Height / Depth	1650 mm / 2600 mm / 134 mm	65" / 102.4" / 5.3"
Frame color	RAL 9005 deep black	
Column color	Silver anodized	
Packages	Package dimensions WxHxD	Package weight
AF-PY-N12	460 x 1300 x 70 mm / 18.1 x 51.2 x 2.8"	12,1 kg / 26.7 lbs
BP-PYE	1050 x 200 x 150 mm / 41.3 x 7.9 x 5.9"	15 kg / 33.1 lbs
CO10284		
SLWBW..		

DIMENSIONS

in mm / inch

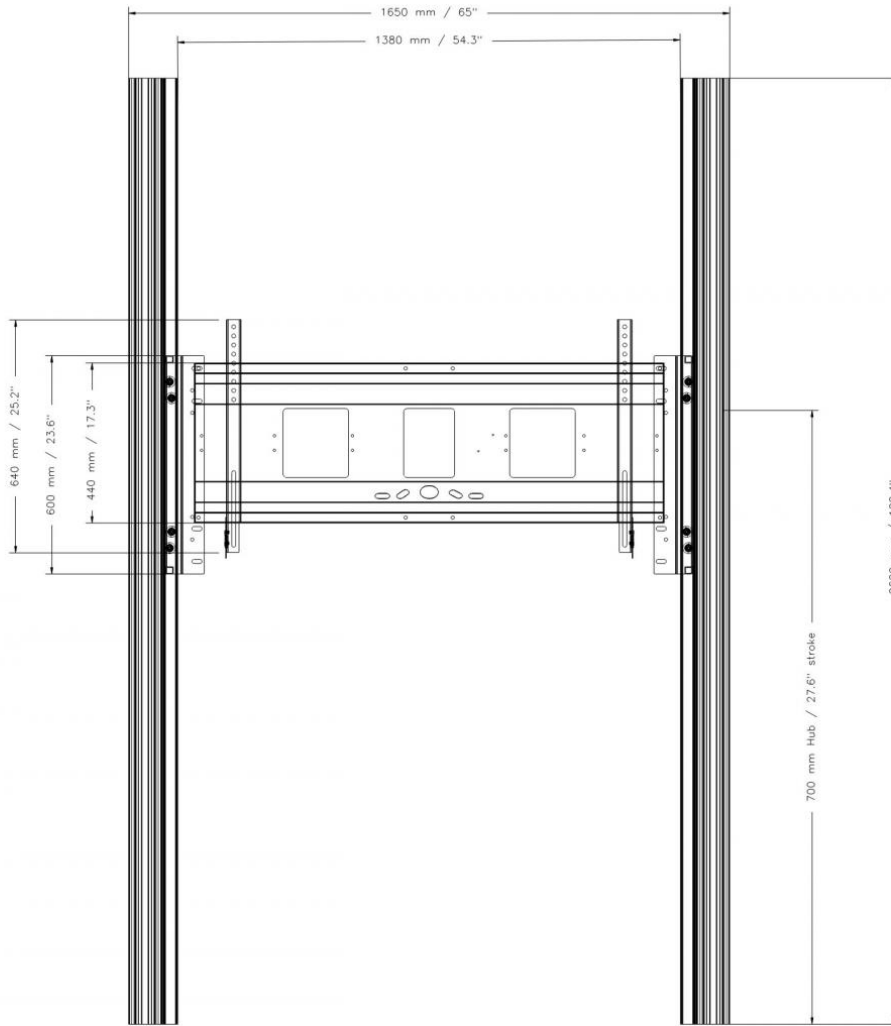

MANUFACTURER:

CONEN Produkte GmbH  
 Conenstr. 4  
 54497 Morbach-Gonzerath

Phone: +49 (0) 6533 75-100  
 Fax: +49 (0) 6533 75-600  
 E-Mail: info@conenmounts.com

Germany

[www.conenmounts.com](http://www.conenmounts.com)