



## SCETANHW17

### FIXED HEIGHT WALLMOUNTING SYSTEM

**Factory:**

Conen Produkte GmbH & Co. KG  
Conenstr. 4  
54497 Morbach-Gonzerath  
Germany

**International sales department:**

Mr. Luc van der Sterren  
Office: +49 65 33 75 311  
Cell: +31 612 495 098  
Email: [Luc@conenmounts.com](mailto:Luc@conenmounts.com)

Mr. Arnaud Gielen  
Office: +49 6533 75 310  
Cell: +49 172 655 84 61  
Email: [Arnaud@conenmounts.com](mailto:Arnaud@conenmounts.com)



## PRRODUCT FEATURES

- ◆ Column, natural anodized
- ◆ Column height: 1700 mm / 66.9"
- ◆ System suitable for wall mounting on massive walls, wall clearance by default 70 mm, 4 leveling feet
- ◆ Display mount for use with 42" – 100"
- ◆ VESA 400 x 200 up to 800 x 600
- ◆ Maximum load approximately 150 kg / 330.7 lbs

## DIMENSIONS

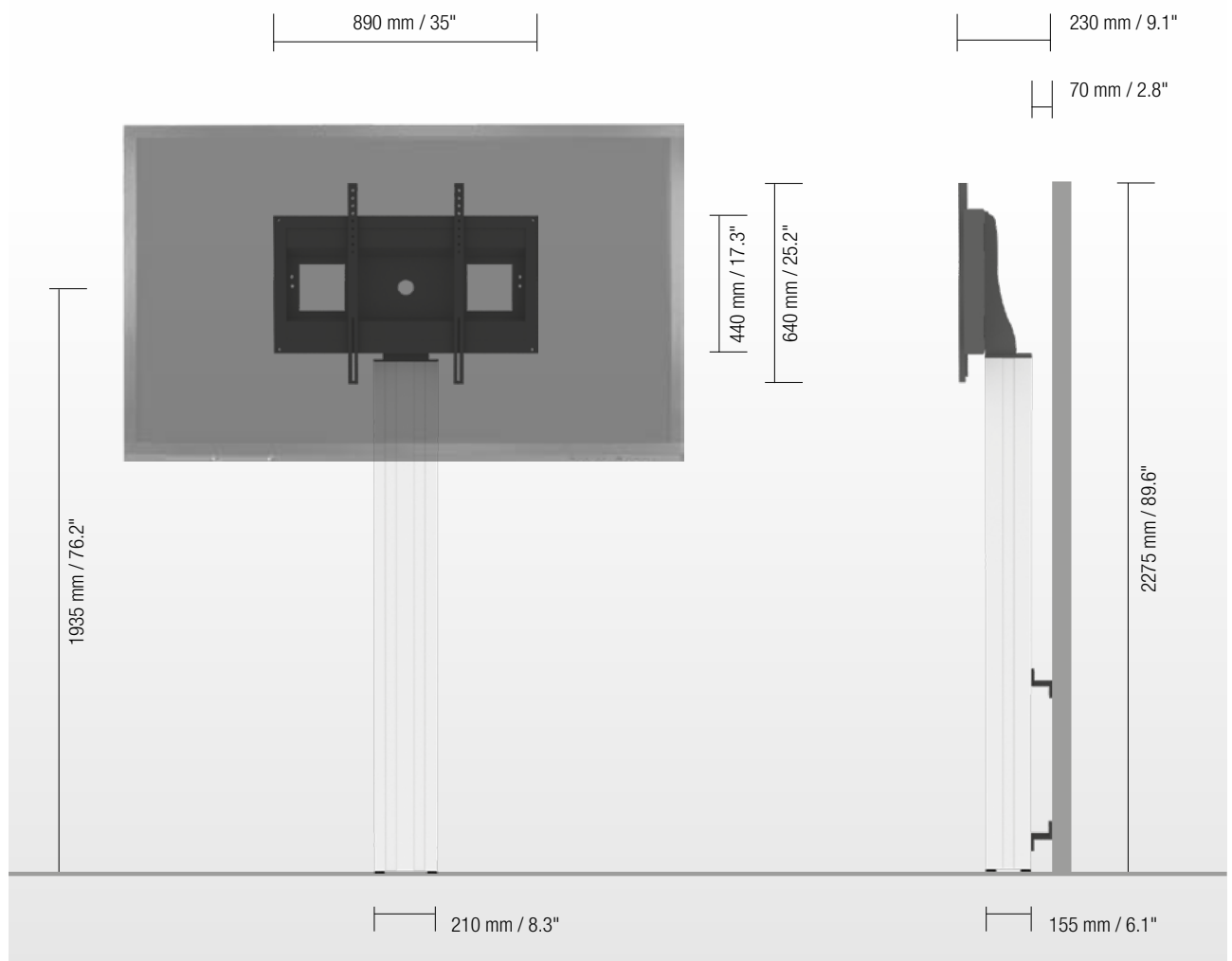

DETAIL VIEWS



Pull & release locking brackets for easier mounting of display



Leveling feet

AVAILABLE ACCESSORIES

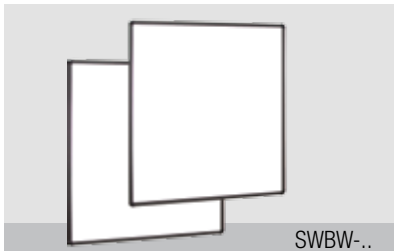

2 whiteboard side wings

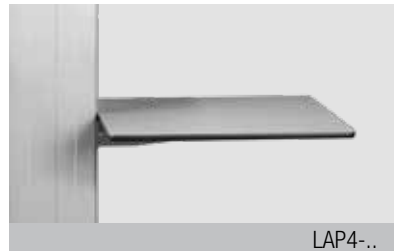

Side shelf



Front shelf



Lockable mini PC bracket



Video conference camera top shelf

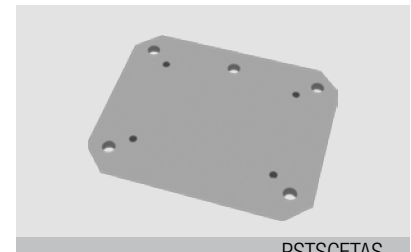

Plate to groundfixing



Keyboard shelf



Video conference camera top shelf

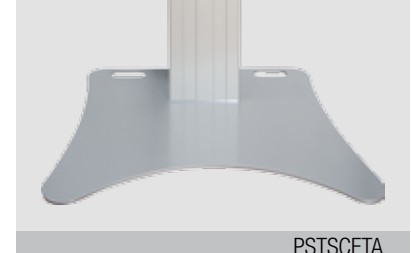

Floor plate



Extender (200 mm / 7.9")



U-shaped wall bracket



Display securing padlock

SIZE INDEX

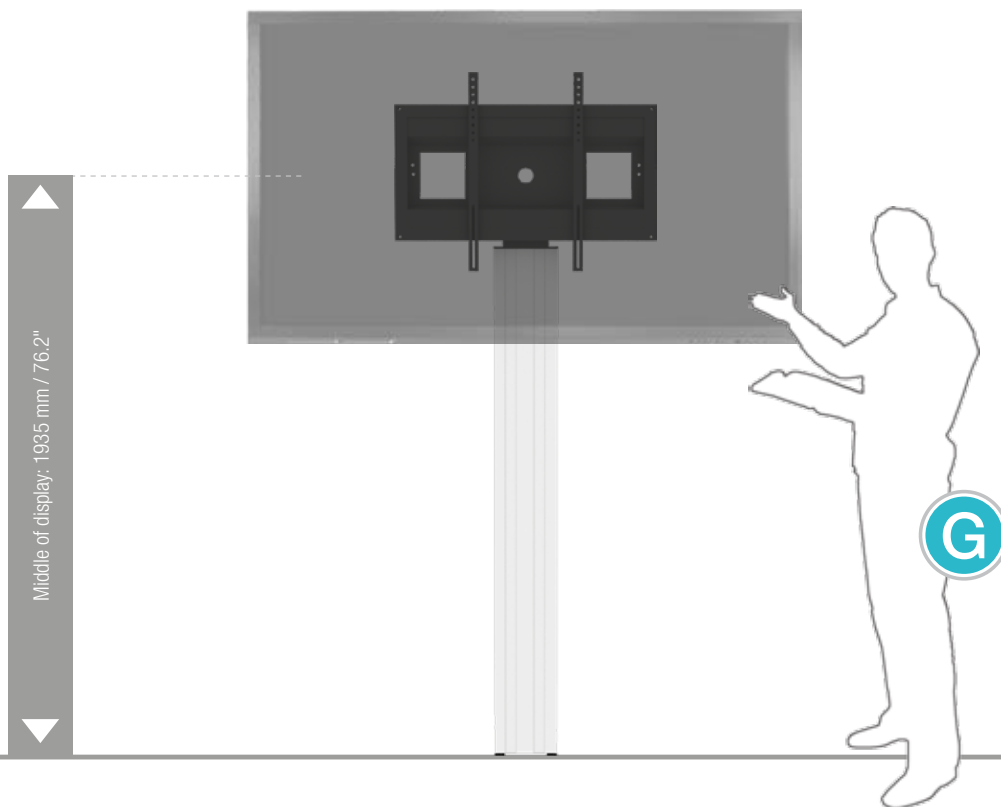

Department	Kindergarten			Primary school		Secondary school		Adults
	A	B	C	D	E	F	G	
Silhouette	A	B	C	D	E	F	G	
Age (years)	2 – 3	3 – 4	4 – 7	6 – 11	11 – 14	13 – 16	from 16	
Body size (mm / ")	930 – 980 37 – 38.6	1080 – 1210 42.5 – 47.6	1190 – 1420 46.9 – 56	1330 – 1590 52.4 – 62.6	1460 – 1765 57.5 – 69.5	1590 – 1880 62.6 – 74	1740 – 2070 68.5 – 81.5	
Color	Green	Purple	Yellow	Red	Light Green	Blue		

PACKING UNITS

Item no.	Description	Packing dimensions (mm / ")	Net weight (kg / lbs)	Gross weight (kg / lbs)
CC-170W	Column, column height: 1700 mm / 66.9", L = 1700 mm / 66.9"	1985 x 270 x 200 / 78.2 x 10.6 x 7.9	25,5 / 56.2	29,9 / 65.9
AF-SCETA-N	Display mount	160 x 900 x 450 / 6.3 x 35.4 x 17.7	11,7 / 25.8	13,6 / 30
Total weight			37,2 / 82	43,5 / 95.9